

# Read 'awl' about it

The Lockdown Newsletter from

## The Cannock Chase Shed

Issue No. 29

Submissions and suggestions to Bob Mason at:

[shednewsletter@virginmedia.com](mailto:shednewsletter@virginmedia.com)

week ending Sat 29<sup>th</sup> May 2021

### In This Issue....

- Shed news
- Meet the Committee
- Notices
- Crossword No 7
- Spot the Difference
- Dingbats No 6
- Sudoku 25-28
- Project - Paul Philips Garden Shed Part 2
- Project - SawHorses
- Wordsearch – British Mammals
- Humour
- Latest Scams
- Project - Amorire
- Answers to Puzzles



# Shed News

## **Cannock Chase Shed Zoom Webchats**

These are still taking place at **10.30 am each Monday**

**Committee meetings are held on Tuesdays**

(for committee members only)

If you'd like to drop in, please contact Barry ([barrykjames@yahoo.com](mailto:barrykjames@yahoo.com)) who will help you to get set up, and send you an invitation to join the meeting.

## **Check our webpage...**

...for information about our Shed, updates about reopening and back issues of the newsletter.

<https://cannockchaseshed.org.uk/>

## **We are on Facebook...**

Remember we have a Facebook page, where you can chat with friends, exchange ideas or ask for advice, as well as sharing your projects.

If you are having trouble finding the bits you need for your project, why not post a request? Another member may have just what you're looking for sitting unused in their garage, or they may know where you can get one.

If you have useful items that you are loath to throw away, why not put up a post, offering them to other members, before consigning them to the tip?

Official Facebook page: Private Group

<https://www.facebook.com/groups/cannockchaseshedders>

## Meet the Committee

<b>Dave Shaw</b>	<b>Chairman</b>
<b>Leslie Jukes</b>	<b>Deputy chairman</b>
<b>Barry James</b>	<b>Health &amp; Safety</b>
<b>Avril Green</b>	<b>Fundraising/Secretary</b>
<b>Graham Johnson</b>	<b>Treasurer</b>
<b>Tim Cutler</b>	<b>Project Manager</b>

## Shed Media

<b>Peter Ross</b>	<b>Website/Facebook Group</b>
<b>Bob Mason</b>	<b>Newsletter</b>

## Could you...



- Sort through your photos and send me a picture and a few words? – your pet, garden, favourite holiday, your most useful tool, a current or past project, a cooking success (or disaster) or favourite recipe? – Pretty much anything you like.
- send me a suggestion of something you'd like to see included in the newsletter? – anything from just a broad idea, to a finished article.
- send in a 'reader's letter'? Share an anecdote or treasured memory? Share your expertise with those who have less experience?
- Send in something else, or help in another way that I haven't even mentioned?

Or if your shy pass it to one of the committee!!

## Notices

1. If anyone has changed their phone number or email address since first joining the Shed can they please send the new details to Graham at [enquiries@cannockchaseshed.org.uk](mailto:enquiries@cannockchaseshed.org.uk) so he can update his records.

2. **Diary Dates:**

**7<sup>th</sup> June** - First day we get the keys to open the Shed – Committee only.

There is work to be done inside and out to prepare for full opening.

**14<sup>th</sup> June** -- Committee only\*

**21<sup>st</sup> June** -- Committee only\*

\* Members are welcome to drop in between 10 – 4 for informal chats (outdoors only) under the usual Covid restrictions.

**28<sup>th</sup> June** – Hopefully open to Members. We're working on it. More details to follow.

**3<sup>rd</sup> August** – 10:30 Shed AGM (Provisional)

# Crossword #7

## Across

1. Second to none
5. Hurling weapon
10. Like some testimony
14. Fond of
15. Caddie's offering
16. Firefighting need
17. Film based on a novel, e.g.
19. Teaspoonful, maybe
20. U-boat, briefly
21. Send out
22. Weight watcher
24. \_\_\_\_ of passage
26. Black gold
28. Foul
29. Beauty parlor
30. Hang around
32. The "U" in I.C.U.
33. Trusted teacher
34. De Niro film, "City By The \_\_\_\_"
37. Dermal affliction
39. Part of PTSD
41. Kicker's aid
42. Fasten (to)
46. Mark of a ruler
47. Take the pulpit
48. Evaluate, as ore
49. Cartoon hedgehog
52. Fish delicacy
53. Wedding wear
54. Throat soother
56. Back of the neck
58. "The Hundred Secret Senses" author
60. Farm cry

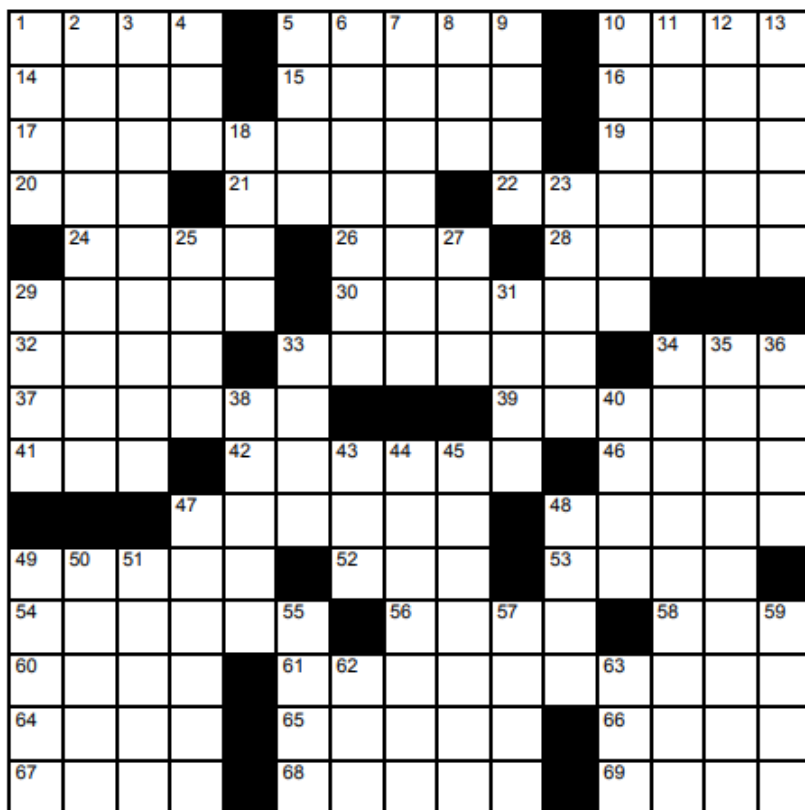

61. Type of pact
64. Ship's backbone
65. Supply party food
66. State with conviction
67. "What \_\_\_\_?"
68. Four-legged laughter
69. Smart-alecky

## Down

1. Skewed view
2. Marathoner's trait
3. Hold firm
4. Lonely place?
5. Emulated Spitz
6. Leafstalk
7. Book version
8. Long \_\_\_\_

9. Tear to bits
10. Cry of dismay
11. Alex Haley classic
12. Strong suit
13. Distrustful
18. Prom attendee
23. Like some gases
25. Shopper's aid
27. Blitzed
29. Feeder filler
31. Reggae great Peter
33. Pal, in Perth
34. Easily offended
35. Moving stairway
36. Grayish
38. Month for some Pisces

40. Bailiff's request
43. Old salt
44. Monkshood
45. Lessen the value of
47. Predicament
48. State categorically
49. Feed, as a fire
50. Large bay window
51. Canonical hour
55. Carve in stone
57. Medic or legal starter
59. Small salamander
62. Beam of light
63. Keg opening

Free printable courtesy of PrintitFree.net

# SPOT THE DIFFERENCE

Can you spot the 8 differences between these two pictures?

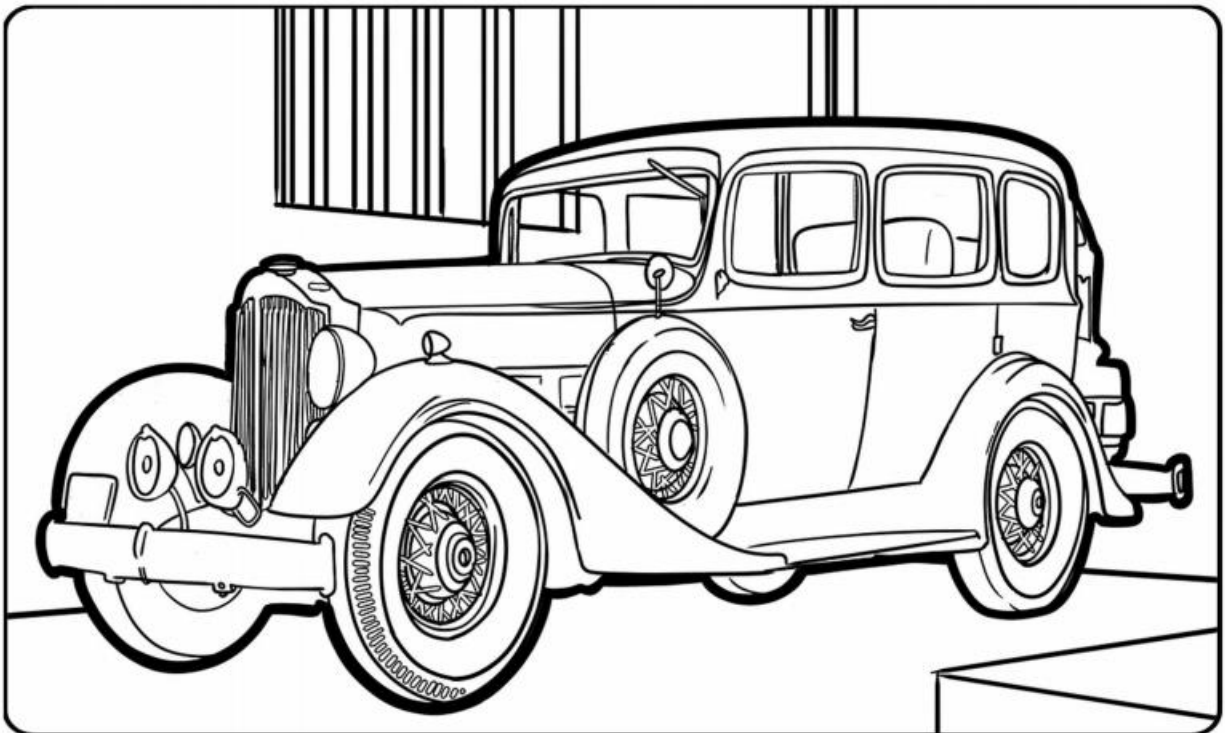
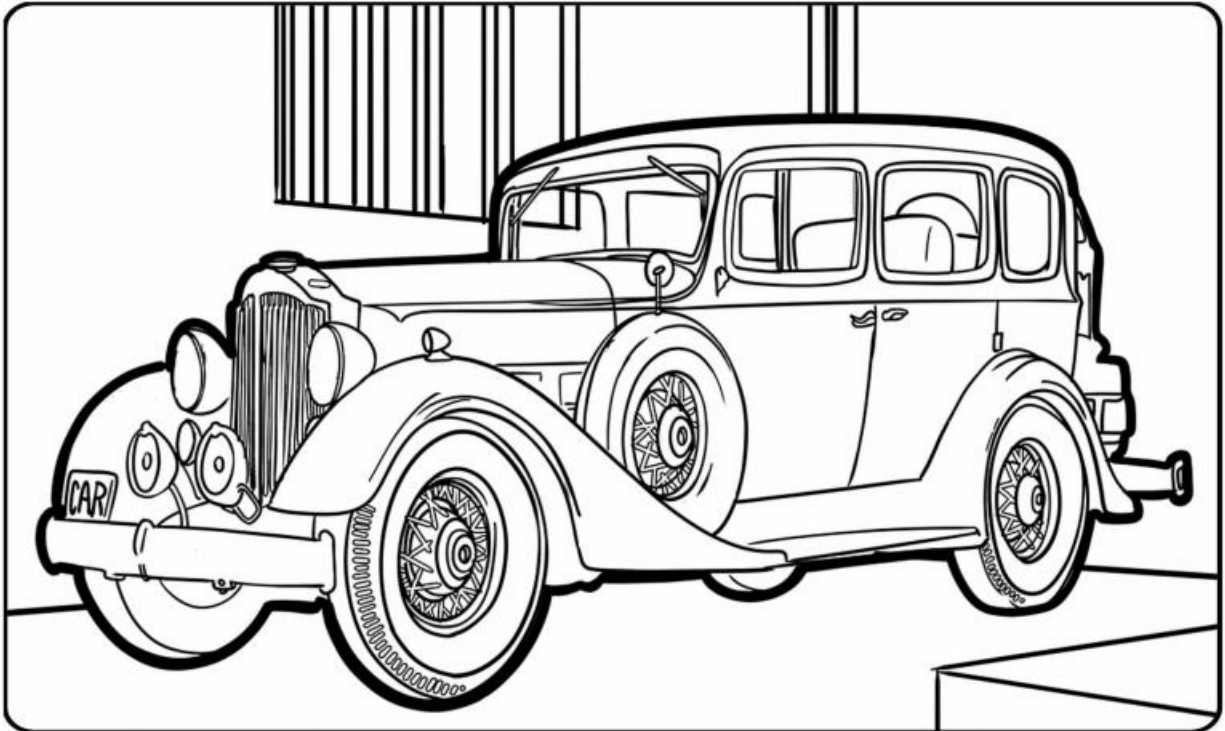

Free printable courtesy of PrintitFree.net



# DINGBATS no. 6

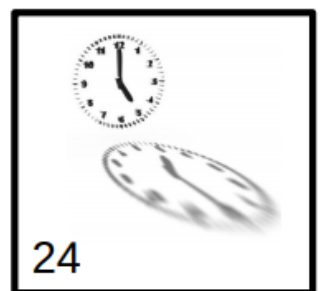
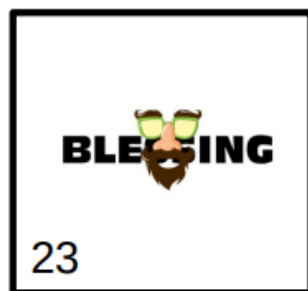
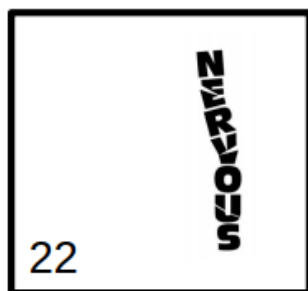
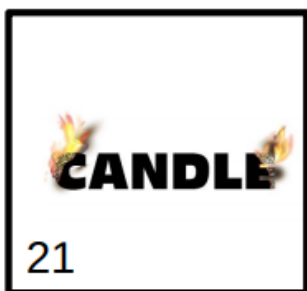
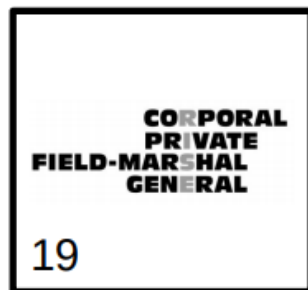
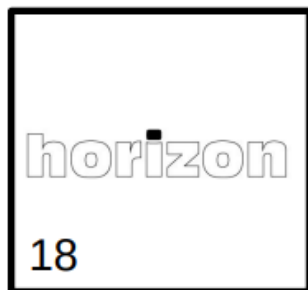
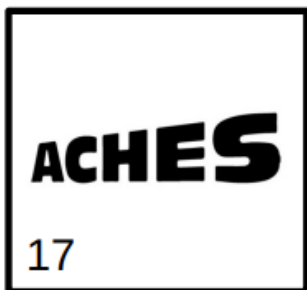
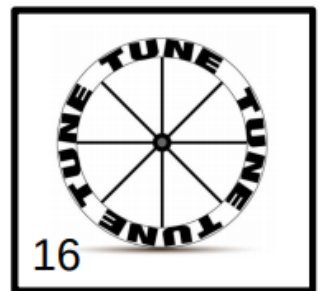
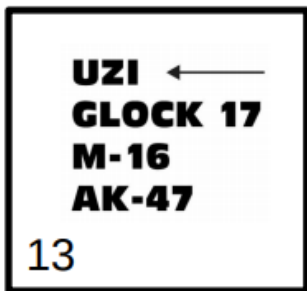
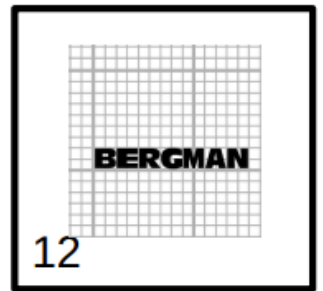
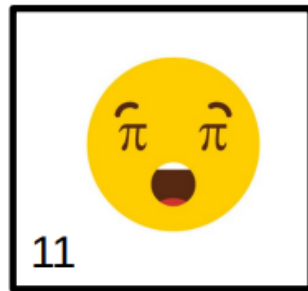
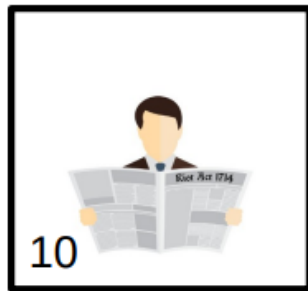
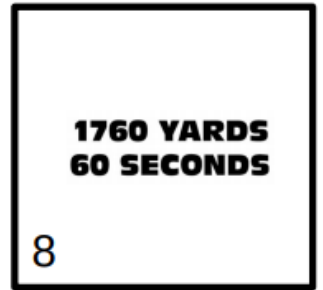
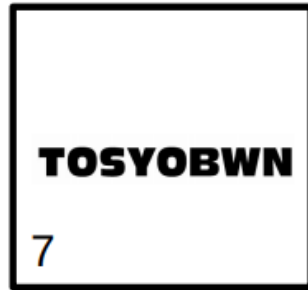
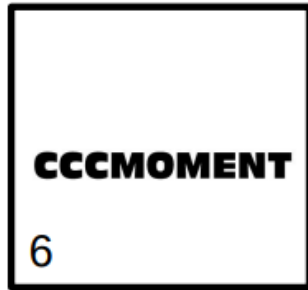
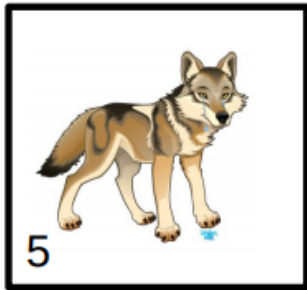
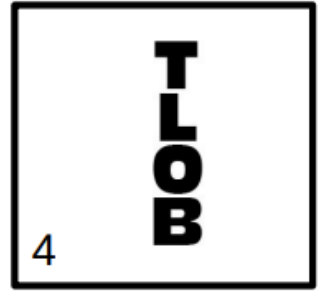
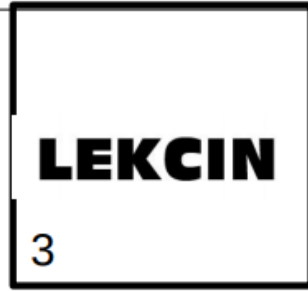
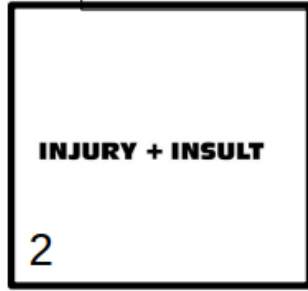

## Sudoku 25

7				1				
			6	2			8	
3		5				7	1	
	8			1				
		7	2			6	5	4
					3		2	
8			1				4	
	9	2						6
4			7			5		8

## Sudoku 26

1				2			7	9
		5						1
	9	7	6			2		
								6
5		4	1	8	6			7
	1		3	5				4
8					9			
		3				1		
					5	4	6	2

## Sudoku 27

5	7							
		6		3	5			4
4	8		7				1	
7					4		6	3
	9			2		1		
	6		3				2	
		8	9	5				
	4					7	9	
				1			3	

## Sudoku 28

			1	3	7	4		2
		4			2	6		
	7					1		
	6			9		7		
	3	7					2	
			6					5
	8	9		6	1		3	
3	5							
		6			8			7



## Project – Paul Philips Garden Shed Part 2

The garden shed arrived and assembled, given one coat of Cuperinol fence life now it's time to fitout.



Wonder what going in it  
Eh!, Pub , Disco, Man Cave



## Project -SawHorses



# Shop Notes

## Sawhorses

**Sawhorses come in all types—from wobbly knocked-together versions to hardwood fine furniture. I built these to hold a Chuck Merrel designed dinghy during construction.**

There really isn't much to these sawhorses. Including the sacrificial strips, each one takes about 24 feet of straight 2 X 4 lumber, and maybe three feet of 1 X 2 for the side braces. This leg length puts the top surface 31 inches from the floor. For me, this works out to just about knuckle-high.

Cut the top pieces to length, and rip the bevel down one side of each. Put the top pieces on a flat surface, spaced apart by a sacrificial strip, and measure for the cross bars. Cut these with a 14 degree bevel on each end. Glue and screw the tops and cross bars together. Cut the legs to length with a 14 degree bevel on both ends. Glue and screw the legs to the ends of the tops. Cut some 1 X 2's to length, bevelling the ends to 14 degrees, and attach them as side braces.

Most of the time I leave the sacrificial strips off. This leaves a wider surface to work on. I put the strips back in whenever I'm going to cut large sheets of plywood. If you set your depth of cut to slightly more than the plywood thickness you can saw right over the sawhorse without having to reposition the work. When the strip gets too chewed up, replace it.

Thin plywood needs a cutting frame under it, otherwise it sags and buckles, resulting in poor cuts and kickbacks. A frame of 2 X 4's about 42 inches by 90 inches would be about right. This frame fits the gap for the sacrificial strips.

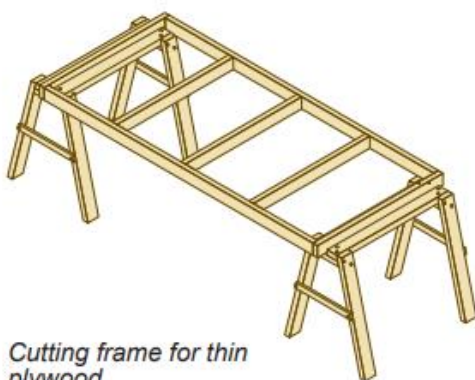

Cutting frame for thin plywood

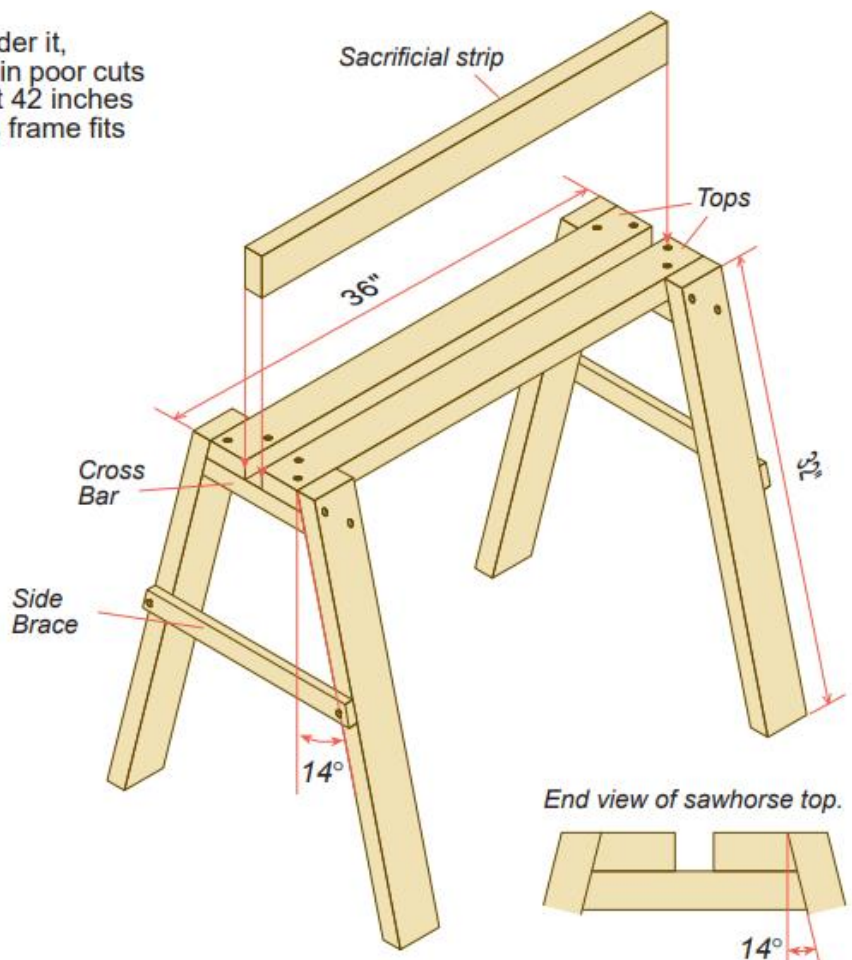

# Wordsearch

## British Mammals

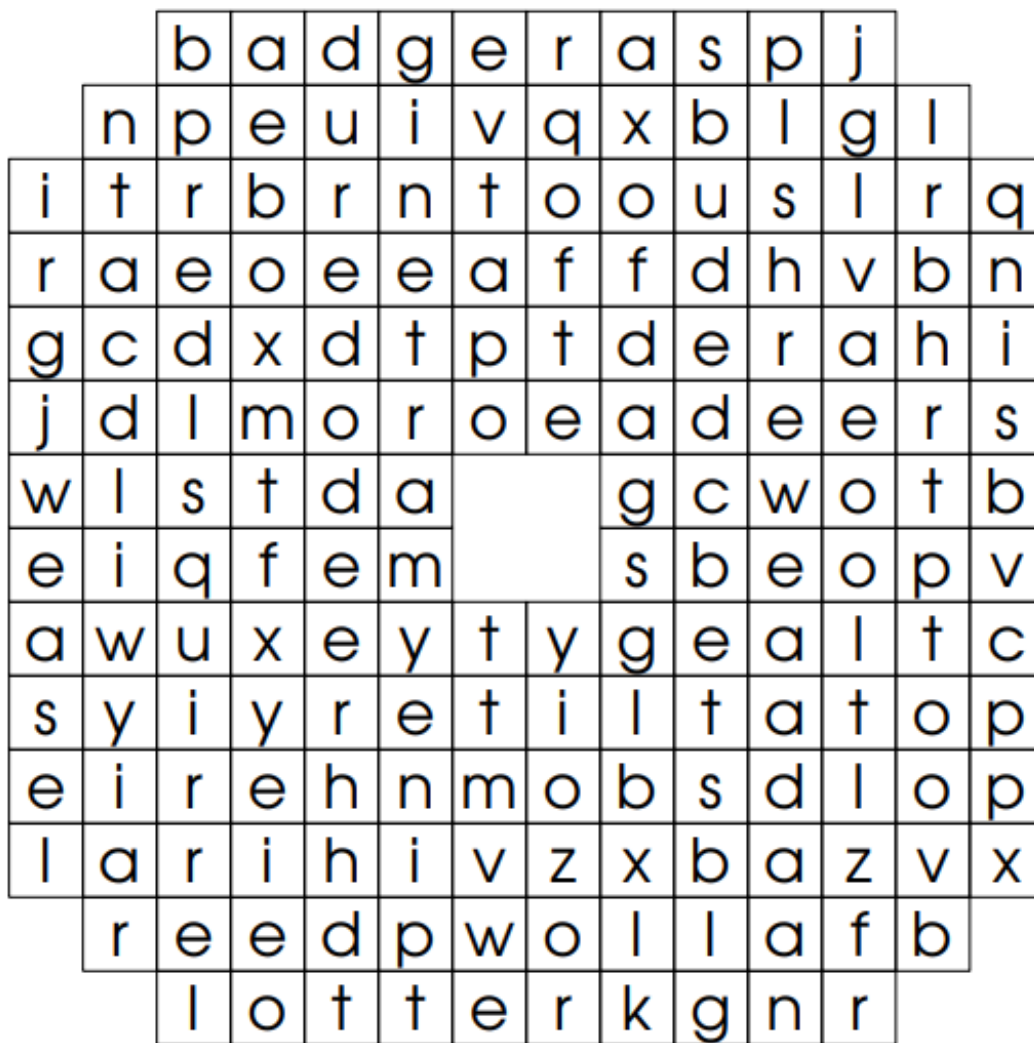

vole  
shrew  
rabbit  
hare  
fox  
wildcat  
badger  
otter  
stoat

weasel  
pine marten  
polecat  
bat  
red deer  
fallow deer  
roe deer  
seal  
red squirrel



# Humour

It took me a few seconds to realize this wasn't a gorilla walking on the beach.



AT MY AGE, ROLLING OUT OF BED IN THE MORNING IS THE EASY PART.

GETTING OFF THE FLOOR IS A WHOLE OTHER STORY.



My wife just said "You weren't even listening were you?"

And I thought that was a weird way to start a conversation.

Not sure if I washed the spider down the drain in my shower or if he took one look at me naked and then leapt willingly to his death.

**JUST SPENT 45  
MINUTES ON THE  
TREADMILL.  
TOMORROW MY  
GOAL IS TO TURN  
IT ON.**

**Ill never forget the  
look on the cashiers  
face, when she  
scanned the packet of  
bird seed,  
And I asked her how  
long does it take for  
the birds to grow once  
I plant them.**

**Red bull may give you  
wings**



**But black bull makes you  
walk on water!**

**Since the snow  
came all the wife  
has done is look  
through the  
window...  
If it gets any  
worse, I'll have  
to let her in....**

**A suspect was charged  
with killing a man with  
sandpaper, in my  
defence he said, "I only  
intended to rough him up  
a bit"**



## Humour

**We all know**  
coffee and jelly beans  
**mirrors don't lie...**



**I'm just grateful that  
they don't laugh.**

COFFEE AND JELLY BEANS

**Don't you hate it when  
you clean out your  
freezer and find  
people you don't even  
recognize?**

**Got granted one  
wish by a genie.  
I said I wanted to  
be happy.  
I'm now living in  
a cottage with 6  
other dwarfs.**

**Six Important Guidelines in Life:**



1. When you are Alone, Mind your Thoughts.
2. When you are with Friends, Mind your Tongue.
3. When you are Angry, Mind your Temper.
4. When you are with a Group, Mind your Behavior.
5. When you are in Trouble, Mind your Emotions.
6. When God starts Blessing you, Mind your Ego.



# Humour

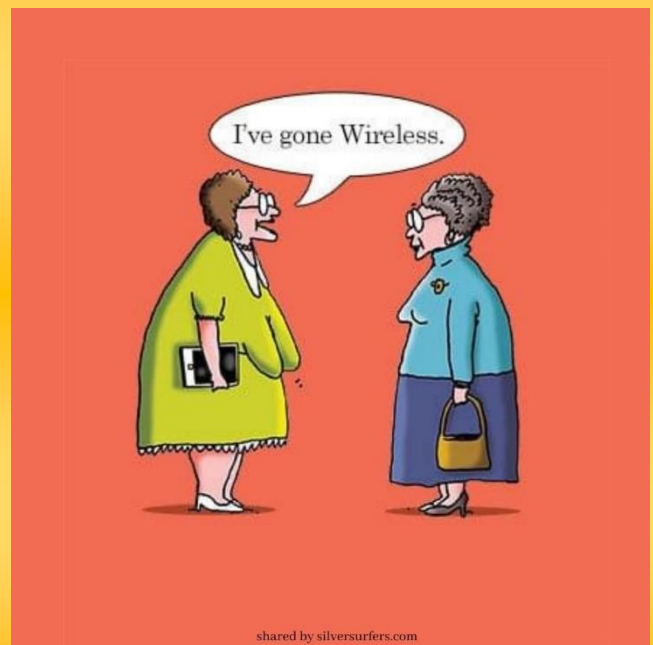

# Latest Scams

## How investment scammers are operating nowadays

Scammers can easily use paid-for adverts on search engines such as Google and Microsoft's Bing to target victims. They also repeatedly pose as legitimate companies, creating convincing websites and application forms to trick investors.

[The latest financial firms being spoofed](#) include online investment platform Interactive Investor and global bank ING.

[A closer look at the fakes](#)

## Update: National Insurance number phishing emails

A few weeks ago we informed you about fraudsters pretending to be from the National Crime Agency or 'National Office for Serious Crimes' cold calling members of the public trying to convince them that their National Insurance number has been compromised.

This time it's in the form of phishing. [Here's an example of the email](#), how fraudsters may pressure you into giving up your details and how you can protect yourself.

[Pressure tactics](#)

If you've received an email from Which? that you suspect to be a scam, please get in touch: [which.co.uk/contact-us](https://www.which.co.uk/contact-us)

Stay safe,

Which? scam alert team

PS Please share this information with your friends, family and neighbours – anyone who may find it helpful. Or they can [sign up here](#) to receive this directly to their inbox.

You're receiving this email because you signed up to the Which? scam alert service.

## Project – Armoire

### **A**rmoire

*This attractive and practical two-door armoire takes up very little floor space in a bedroom but provides lots of storage. Because it is only a little over 1 foot deep, it's easy to incorporate into almost any room, yet it conveniently keeps socks, sweaters, ties, and belts organized and handy.*



## **Materials**

- 6 linear feet of 1 x 1 pine
- 40 linear feet of 1 x 4
- 28 linear feet of 1 x 6
- 38 linear feet of 1 x 12
- 16 linear feet of 3-inch-wide crown molding
- 2 sheets (4' x 8') of 1/4" plywood
- 4 porch post finials, 7-1/2 inches long\*
- 2 linear feet of wooden closet rod (optional)

## **Hardware**

- 110 3/4" wire brads
- 52 1-1/4" 3d finishing nails
- 40 2" 6d finishing nails
- 44 1" wood screws
- 110 1-1/2" wood screws
- 6 cabinet door hinges
- 2 door pulls
- 2 cabinet catches

## **Special Tools and Techniques**

- Bar clamps or pipe clamps
- Miters
- Rabbets

## **Cutting List**

Code	Description	Qty.	Materials	Dimensions
A	Top/Bottom	2	1 x 12 pine	42-1/4" long
B	Side	2	1 x 12 pine	61-1/4" long
C	Center Divider	1	1 x 12 pine	61-1/4" long
D	Shelf	8	1 x 12 pine	20" long
E	Shelf Support	6	1 x 1 pine	11-1/4" long
F	Back	1	1/4" plywood	42-1/4" x 62-3/4"
G	Side Trim	4	1 x 4 pine	11-1/4" long
H	Front Trim	2	1 x 4 pine	43-3/4" long
I	Crown Molding	6	3" crown molding	Cut to fit
J	Drawer Front/Back	10	1 x 6 pine	19-7/8" long
K	Drawer Side	10	1 x 6 pine	9-5/8" long
L	Drawer Bottom	4	1/4" plywood	10" x 18-3/4"
M	Top/Bottom Door Trim	4	1 x 4 pine	21" long



N	Side Door Trim	4	1 x 4 pine	61" long
O	Door Panel	2	¼" plywood	14-1/2" x 54-1/2"
P	Leg	4	Porch post finials*	7-1/2" long

### **\*Notes on Materials**

The legs for our armoire are actually porch post finials which we purchased in a building supply store. The exact shape doesn't matter, but they should be at least 7-1/2 inches long. If you can't find the exact finials that we used, you can lengthen the finials by attaching a 2 x 4 block under the lower trim on the armoire, and then attaching the finials to those blocks.

### **Building the Armoire Outer Case**

1. Cut two top/bottoms (A) from 1 x 12 pine, each measuring 42-1/4 inches.
2. Cut two sides (B) from 1 x 12 pine, each measuring 61-1/4 inches long.

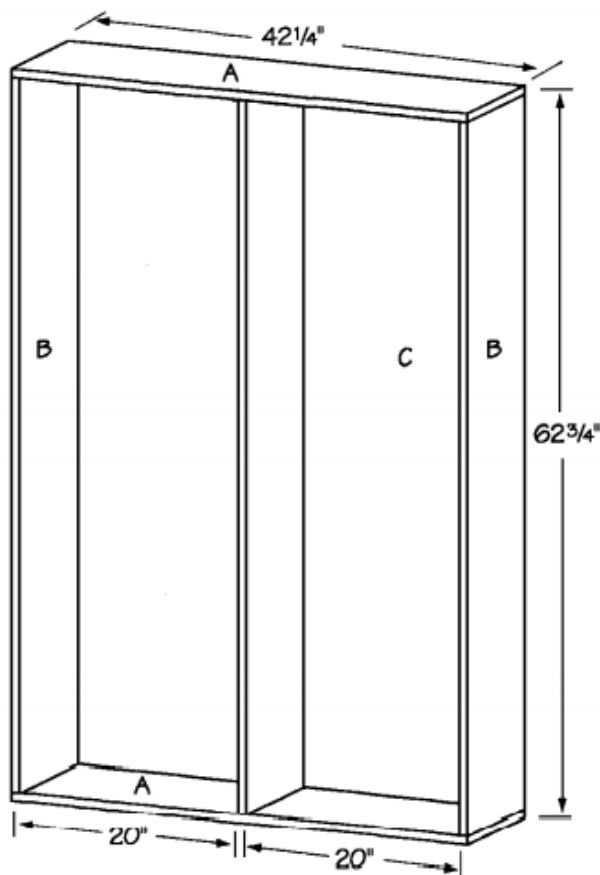

**Figure 1**

3. Place the two sides (B) on edge on a level surface, parallel to each other and 40-3/4 inches apart. Place the two top/bottoms (A) over the ends of the two sides (B), as shown in *Figure 1*. Screw through the top/bottoms (A) into the two sides (B) using four evenly spaced 1-1/2-inch screws on each joint.
4. Cut one center divider (C) from 1 x 12 pine, measuring 61-1/4 inches long.
5. Place the center divider (C) in the center of the armoire assembly, parallel to and 20 inches from each of the sides (B), as shown in *Figure 1*. Screw through the top/bottoms (A) into the center divider (C) using four evenly spaced 1-1/2-inch-long screws on each joint.
6. Cut eight shelves (D) from 1 x 12 pine, each measuring 20 inches long.

7. Refer to *Figure 2* to place five shelves (D) on the right side of the armoire case. Note that the upper shelf (D) is 28-3/4 inches below the top/bottom (A), and that the remaining four shelves (D) are spaced 5-3/4 inches apart. Screw through the side (B) and center divider (C) into the five shelves (D). Use four evenly spaced 1-1/2-inch-long screws on each joint.
8. Refer to *Figure 2* to place the three remaining shelves (D) on the left side of the armoire case. Note that the upper shelf (D) is 14-3/4 inches below the top/bottom (A), and that the remaining two shelves are spaced 14-3/4 inches apart. Apply glue on the meeting surfaces, and screw through the side (B) and center divider (C) into the three shelves (D). Use four evenly spaced 1-1/2" screws on each joint.

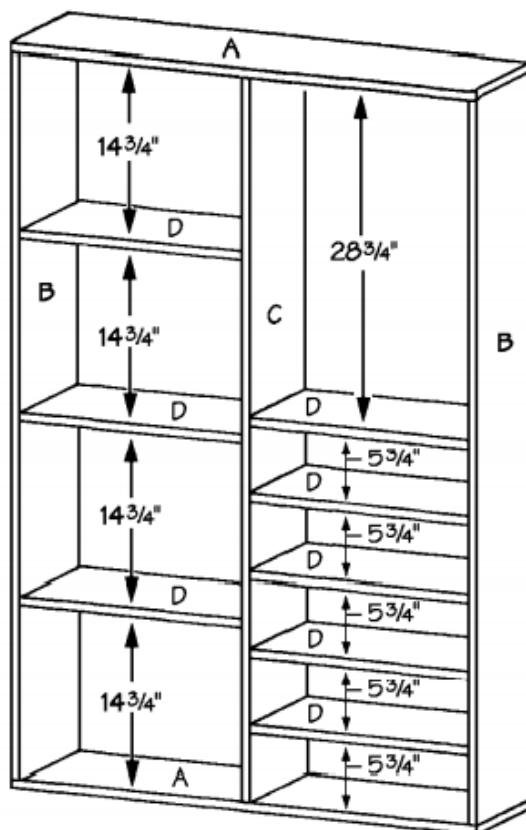

*Figure 2*

9. Cut six left shelf supports (E) from 1 x 1 pine, each measuring 11-1/4 inches long.
10. Glue and nail one shelf support (E) under the left side of the upper shelf (D), as shown in *Figure 3*. Apply glue on the meeting surfaces, and nail through the shelf support (E) into the shelf (D) and the side (B) using three 1-1/4-inch nails in each direction.
11. Repeat Step 10 five more times to install a shelf support (E) under each side of each left shelf (D), as shown in *Figure 3*.
12. Cut one back (F) from 1/4" plywood, measuring 42-1/4" x 62-3/4".
13. With the armoire case lying on its front, apply glue to the back edges of the top/bottoms (A), sides (B) center divider (C), and shelves (D). With the help of a friend, lay the back (F) on the armoire case, matching all outside edges. Screw through the back (F) into the edges of the top/bottoms (A), sides (B) and center divider (C), using 1-inch screws spaced 6 inches apart.



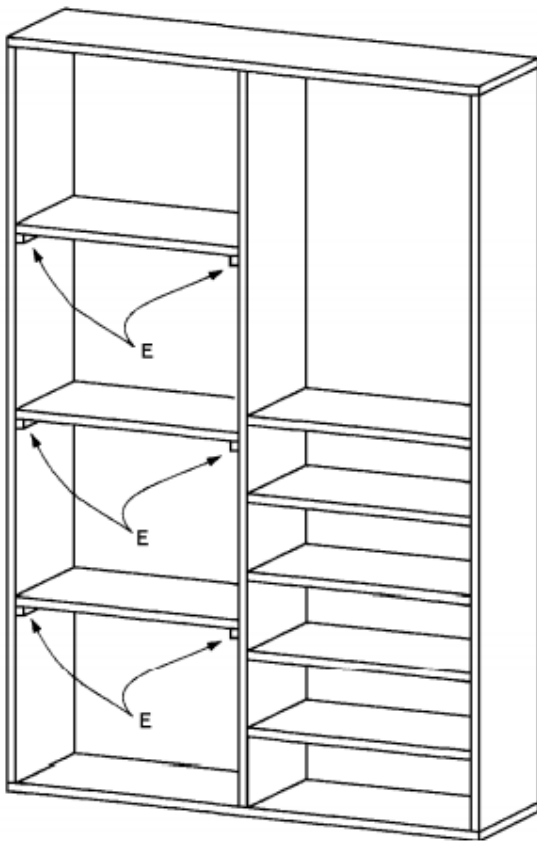

Figure 3

## Adding the Trim

1. Cut four side trims (F) from 1 x 4 pine, each measuring 11-1/4 inches long.
2. Place the armoire case on its back on a level surface. Apply glue on the meeting surfaces, and screw one side trim (G) to the top of the armoire case, covering only the edge of the top/bottom (A), as shown in *Figure 4*. Screw through the side trim (F) into the top/bottom (A), using four evenly spaced 1-1/2-inch screws.
3. Repeat Step 2 three more times to attach the remaining three side trims (G) to the top/bottoms (A) on the bottom and top of the armoire case.
4. Cut two front trims (H) from 1 x 4 pine, each measuring 43-3/4 inches long.
5. Apply glue on the meeting surfaces, and screw one front trim (H) to the top front of the armoire case over the ends of the two side trims (G), as shown in *Figure 4*. Screw through the front trim (H) into the side trims (G) and the edge of the top/bottom (A) using 1-1/2-inch screws spaced every 5 inches.
6. Repeat Step 5 to attach the remaining front trim (H) to the bottom front of the armoire case.
7. The photograph shows the position of the crown molding (I) at the top and bottom of the armoire. Measure carefully and cut lengths of 3-inch-wide crown molding (I) to fit over the front and side trims (G and H), on both the bottom and top of the armoire case. The crown molding (I) should just barely cover the trims (G and H). Apply glue on the meeting surfaces and use 3/4-inch brads spaced about every four inches. If you are inexperienced at cutting crown molding, please refer to the "Tips and Techniques" section.

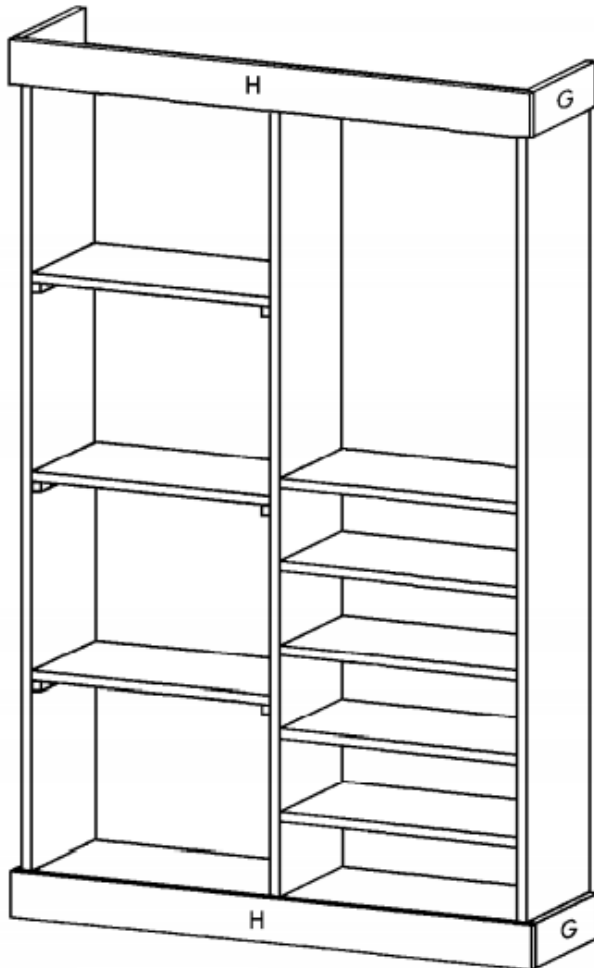

Figure 4

## **Making the Drawers**

There are four identical drawers in this buffet. All four are constructed as shown in the assembly diagram in *Figure 5*.

1. Cut ten drawer front/back (J) from 1 x 6 pine, each measuring 19-7/8 inches long.
2. Cut a half-circle with a radius of 1-3/4" from the center of five of the front/back pieces. These now will be designated the drawer fronts.
3. Cut ten drawer sides (K) from 1 x 6 pine, each measuring 9-5/8 inches long.
4. Cut four drawer bottoms (L) from 1/4" plywood, measuring 10 x 18-3/4 inches.
5. Cut a 1/4 x 1/4-inch dado on the inside of each drawer piece (J and K) 3/8" from the lower edge to accommodate the plywood bottom.

6. Assemble one drawer as shown in *Figure 5*. Note that the drawer front/back pieces (J) overlap the ends of the drawer sides (K). Use two 2" 6d finishing nails through each end of the overlapping drawer front/back (J).
7. Repeat the drawer assembly four more times using the remaining eight drawer front/back pieces (J), the eight drawer sides (K), and the four drawer bottoms (L).

## **Making the Doors**

1. Cut four top/bottom door trims (M) from 1 x 4 pine, each measuring 21 inches long.
2. Miter each of the four top/bottom door trims (M) at opposing 45-degree angles, as shown in *Figure 6*.

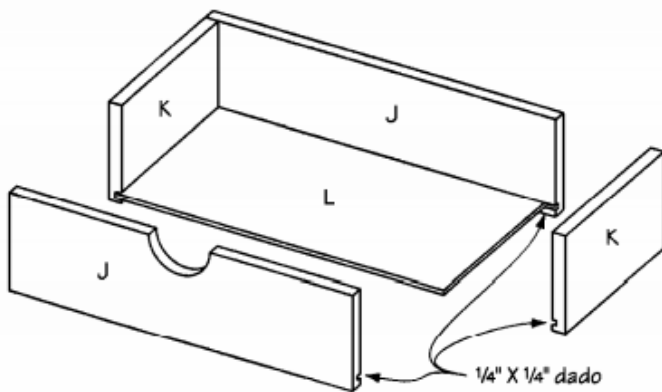

Figure 5

3. Cut four side door trims (N) from 1 x 4 pine, each measuring 61 inches long.
4. Miter each of the four side door trims (N) at opposing 45-degree angles, as shown in *Figure 6*.
5. Cut a  $\frac{1}{4}$  x  $\frac{1}{4}$  inch rabbet on the inside edges of the backs of the door trims (M and N), as shown in *Figure 6*.

6. Cut four door panels (O) from  $\frac{1}{4}$ -inch plywood, each measuring 14- $\frac{1}{2}$ " x 54- $\frac{1}{2}$ ".
7. Place two top/bottom door trims (M) fronts down, 54 inches apart, and parallel to each other. The miters should oppose each other, as shown in *Figure 7*.
8. Fit two side door trims (N) between the two top/bottom door trims (M), as shown in *Figure 7*. Apply glue on the mitered surfaces and to the rabbets. Lay one door panel into the rabbet and clamp the door assembly together. Nail through the door panel (O) at an angle into the door trims (M and N) using  $\frac{3}{4}$ " brads spaced 4 inches apart. Reinforce the outside of each miter joint by driving one 1- $\frac{1}{4}$ " 3d finishing nail across the joint from each edge, starting about 1 inch from the corner.

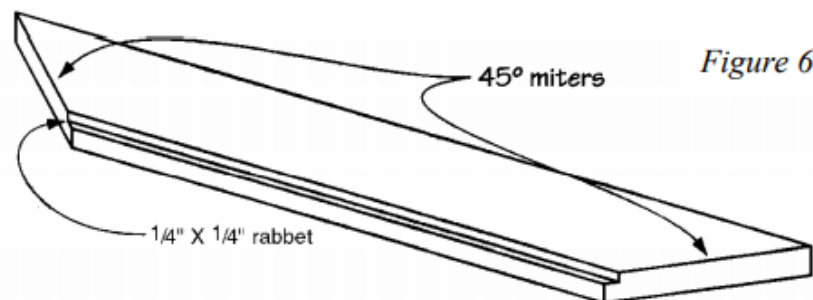
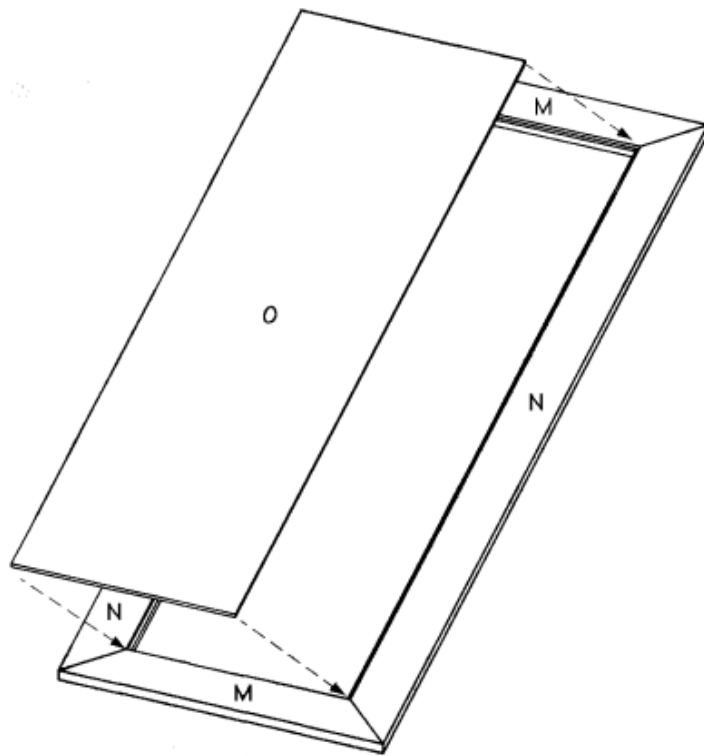

Figure 6

9. Repeat Steps 8 and 9 using the remaining two top/bottom door trims (M) and two side door trims (N) and door panel (O).



*Figure 7*

## **Finishing**

1. Install the legs (P) in the four corners of the bottom of the armoire. Use three 3-inch screws driven through the bottom (A) into the top of each leg (P).
2. Fill the screw holes, crevices and cracks with wood filler.
3. Sand all surfaces of the completed armoire.
4. Install the cabinet doors on the completed armoire using three hinges on each door.
5. Install the closet rod (optional) on the right side of the armoire.
6. Stain or paint the armoire the color of your choice. We chose paint our armoire a bright white, and then sealed it with polyurethane.
7. Install the door pulls and catches.

# Answers to Puzzles

## Solution for Crossword #7



## DINGBATS no. 6 answers

- |    |                           |    |                              |
|----|---------------------------|----|------------------------------|
| 1  | fill in the blank         | 13 | top gun                      |
| 2  | add insult to injury      | 14 | fancy that                   |
| 3  | Nickelback                | 15 | magic circle                 |
| 4  | bolt upright              | 16 | wheel of fortune             |
| 5  | crying wolf               | 17 | growing pains                |
| 6  | seize the moment          | 18 | a dot on the horizon         |
| 7  | the boys are back in town | 19 | rise through the ranks       |
| 8  | a mile a minute           | 20 | all the tea in China         |
| 9  | Eminem                    | 21 | burn the candle at both ends |
| 10 | read the riot act         | 22 | nervous breakdown            |
| 11 | pie eyed                  | 23 | blessing in disguise         |
| 12 | Ingrid Bergman            | 24 | five o'clock shadow          |



### Sudoku 25 Solution

7	2	8	3	5	1	4	6	9
9	4	1	6	2	7	3	8	5
3	6	5	9	4	8	7	1	2
2	8	4	5	1	6	9	3	7
1	3	7	2	8	9	6	5	4
6	5	9	4	7	3	8	2	1
8	7	6	1	9	5	2	4	3
5	9	2	8	3	4	1	7	6
4	1	3	7	6	2	5	9	8

### Sudoku 26 Solution

1	4	6	5	2	8	3	7	9
2	8	5	9	7	3	6	4	1
3	9	7	6	4	1	2	8	5
7	3	8	2	9	4	5	1	6
5	2	4	1	8	6	9	3	7
6	1	9	3	5	7	8	2	4
8	6	2	4	1	9	7	5	3
4	5	3	7	6	2	1	9	8
9	7	1	8	3	5	4	6	2

### Sudoku 27 Solution

5	7	9	1	4	2	3	8	6
1	2	6	8	3	5	9	7	4
4	8	3	7	6	9	5	1	2
7	1	2	5	9	4	8	6	3
3	9	4	6	2	8	1	5	7
8	6	5	3	7	1	4	2	9
2	3	8	9	5	7	6	4	1
6	4	1	2	8	3	7	9	5
9	5	7	4	1	6	2	3	8

### Sudoku 28 Solution

6	9	5	1	3	7	4	8	2
8	1	4	9	5	2	6	7	3
2	7	3	4	8	6	1	5	9
5	6	1	2	9	3	7	4	8
4	3	7	8	1	5	9	2	6
9	2	8	6	7	4	3	1	5
7	8	9	5	6	1	2	3	4
3	5	2	7	4	9	8	6	1
1	4	6	3	2	8	5	9	7



## Answer to Wordsearch

### British Mammals

